

PINK® THERMAL SLAB AND PINK® NOISESTOP™ FACED GLASSWOOL BOARD

Introduction

This Installation Guide applies to Pink® Thermal Slab and Pink® NoiseSTOP™ insulation supplied in faced board form for under soffit, wall and behind decorative panelling applications.

General Information

- Prior to installation, calculate the amount of insulation and fixings required for the installation.
- Avoid gaps in the insulation, other than where required, around electrical fittings or as specified.
- Avoid compressing or over fixing insulation as this will reduce the thermal performance of the installed product.
- Avoid using multiple small offcuts to fill single areas and opt for larger single pieces, purpose-cut to fill larger gaps.
- All insulation shall be installed in accordance with AS 3999.
- Refer to latest ICANZ Installation Handbook Part 2: Professional Installation Guide for further information and tips.
- Ensure that all safety assessments are carried out relevant to the project and all site safety requirements are strictly adhered to.

Important Notes

- Electric cables and equipment partially or completely covered with bulk thermal insulation may overheat and fail. Refer to AS 3999.
- Prior to and during installation the insulation must be kept dry.
- Where cutting is required, use a sharp knife and straight edge, cutting with power tools is not recommended.
- For commercial roofing applications where spans are greater than 900mm, support (safety mesh or similar) must be provided below the insulation.
- Pink® insulation products are not designed to withstand weathering; hence, ceiling or wall lining should be applied without delay. These insulation products are not suitable for applications where subject to wetting or excessive moisture.

Insulation and accessories required

- Measure the square metre of area to be insulated.
- Coverage of each Pink® Thermal Slab and Pink® NoiseSTOP™ is provided on the relevant Technical Data Sheet.
- Divide the area to be insulated by the coverage per pack to determine the number of packs to order.
- Roughly sketch out the layout of the boards to determine the number of boards, amount of tape required, and fixings
- Allow for wastage. As a general rule, allow for 5% wastage for simple areas and greater allowances for more complex areas.

Tape accessories

- For Pink® Thermal Slab with a silver foil facing, use Vapastop® 883 reinforced foil tape.
- For Pink® NoiseSTOP™ with black Durasorb® poly-woven fabric, use Durasorb® tape.

Tools



Sharp knife

For cutting insulation to size.



Cutting board

Or hard, durable surface.



Tape measure

To measure lengths required.



Straight edge

For cutting.

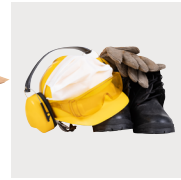

Clothing & PPE

Appropriate wear for site (refer sections below).



Fastening tool

Such as a concrete nail gun.



Ladder

Or scaffolding as needed.

PPE

Personal Protective Equipment (PPE) must be compliant with the requirements of the specific worksite. Check with site foreman or site representative to ensure that required PPE obligations are met. As a recommendation for handling and installing insulation materials, the following PPE is recommended:



Eye protection

Suitable eye protection to AS 1336 reduces the risk of eye contact with dust or fibres.



Gloves

Gloves are recommended, especially when cutting insulation.



Work clothes

Loose fitting clothes, including long sleeved shirts, long pants and cap or hard hat.



Dust mask

A dust mask is recommended when working in dusty areas.



Safety shoes

Safety boots/shoes must be worn to protect feet.



Separate wash

Wash work clothes separately and rinse the washing machine after use.

Safety



Assess

Assess the building structure and site for any safety issues prior to commencing work.



Check

Before entering a ceiling space, make note of the location of equipment in the ceiling such as lighting luminaires, exhaust fans and fire sprinklers.



Stay hydrated

Ceiling spaces can be hot and poorly ventilated, get relief and fresh air regularly and stay hydrated.



Electrical wires

Ensure the work area is safe from hazards including electrical cabling. Do not touch any live electrical cables.



Isolate power

If accredited, isolate power at the circuit board where necessary and apply caution tags to circuit breakers.



Electrician

If not accredited, ask appropriate site representative to isolate power at the circuit board where necessary and apply caution tags to circuit breakers.



Height

Working at height can be dangerous, exercise caution when climbing ladders or accessing elevated platforms.

Concrete soffits and wall applications

- Where required, use a sharp knife to cut the boards to the required size.
- Cut boards against a firm straight surface where no electrical cables or services exist.
- Install the insulation one piece at a time ensuring the boards are supported during installation and not allowed to fold in on themselves.
- Ensure the glasswool face is in continuous contact with the concrete slab.
- Butt the boards closely together to ensure there are no gaps left at joints.
- Install recommended fixings in accordance with **Figure 1** for soffits and **Figure 2** for walls.
- Ensure insulation boards are installed in a brick layout, ie joints are staggered.
- No exposed glasswool fibres should be present. Services, joints and the like are to be taped and sealed accordingly. Seal around any penetrations using an appropriate pressure sensitive tape.
- Prior to any tapes being installed, wipe down area to be taped to ensure any dust that may have settled on the boards to do not inhibit tape adhesion.
- Pink® Thermal Slab and Pink® NoiseSTOP™ insulation may be fixed to the underside of the concrete slabs using suitable fixings such as pin fasteners, drive fasteners etc. Select the appropriate pin length to prevent compressing the insulation.
- Consultation with the chosen fastener supplier is recommended.
- As **Figure 3** illustrates, fixing should be at 8 points, 4 in each corner 100mm from the edge and 2 at the midpoints of each long edge. The remaining 2 should be along the centre line and nominally 600mm from each short edge.
- Seal around any penetrations using an appropriate pressure sensitive tape.
- Restore power and remove caution tags when the job is complete.

Figure 1: Concrete soffit/
underslab thermal slab

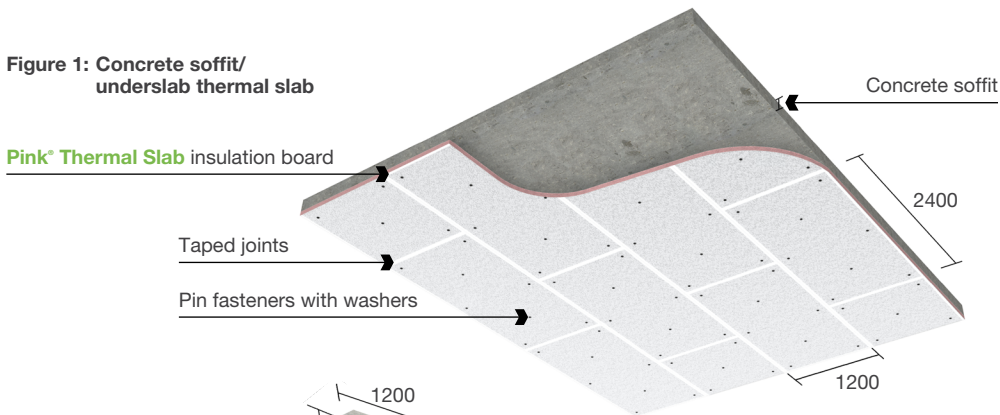

Figure 2: Direct fix to wall
installation

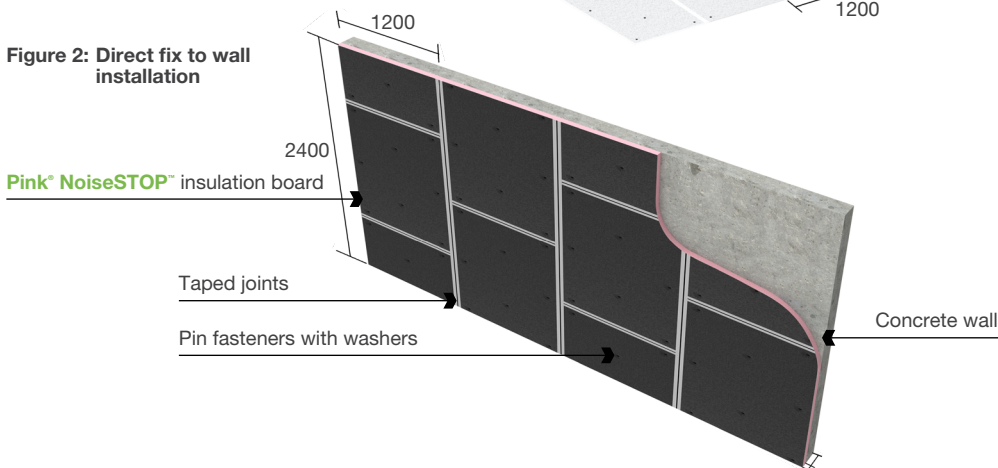
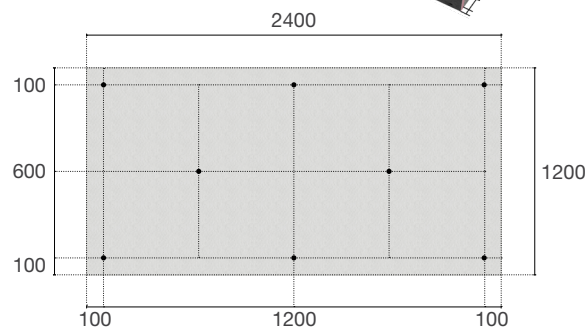

Figure 3: Eight fixing positions
shown on a single sheet
of insulation board



Decorative acoustic panelling

- Pink® Thermal Slab and Pink® NoiseSTOP™ insulation boards may also be fixed behind perforated linings to provide decorative acoustic absorption and to conceal the substrate behind the lining for an enhanced visual appearance. Refer to **Figure 4**.
- Framing and fixings for the linings shall be designed to accommodate the depth of the insulation, while supporting the weight and holding the insulation boards in place.
- Pink® Thermal Slab and Pink® NoiseSTOP™ insulation boards must be installed in accordance with the recommendations above.
- Ensure that decorative panelling does not compress insulation and install decorative panelling in accordance with panelling suppliers recommendations.

Figure 4: Decorative acoustic panelling

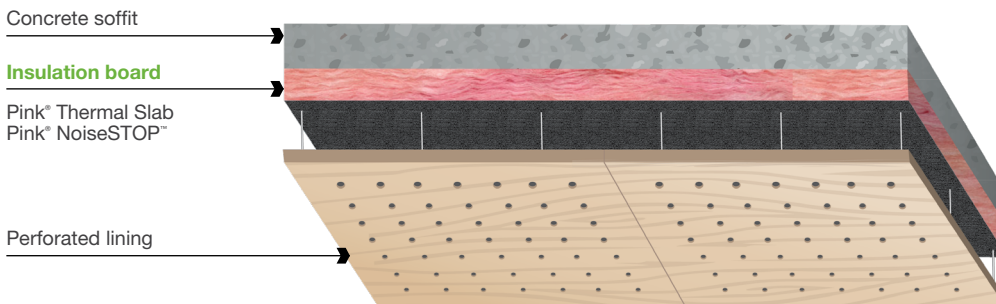

Note: if your application/installation is outside these guidelines, please contact Fletcher Insulation prior to commencing the install to obtain written approval for your specific application.

© Fletcher Insulation Pty Limited 2022. Fletcher Insulation reserves the right to change product specifications without prior notification. Information in this publication and otherwise supplied to users as to the subject product is based on our general experience and is given in good faith, but because of the many particular factors which are outside our knowledge and control and affect the use of products, no warranty is given or is to be implied with respect to either such information or the product itself, in particular the suitability of the product for any particular purpose. The purchaser should independently determine the suitability of the product for the intended application. Unless otherwise stated all ™ and ® are trademarks and registered trademarks of Fletcher Insulation Pty Limited ABN 72 001 175 355. IG10_Revision_3_Issue Date 23052022.

For more information call 1300 654 444
email info@insulation.com.au or web www.insulation.com.au

Fletcher
Insulation
Building Better, Together